



# Jet Mill

Mechanical and hydraulic debris removal

Downhole. Workover. Rentals.

# Jet Mill

- ② Introduction to tool
- ② Features
- ② Benefits
- ② Specs
- ② Contact Information
- ② WOS Overview & Locations



# Jet Mill Overview

- Current recompletion work is two-fold, first involves having an operator perform clean out and jetting runs with a motor and junk mill to mill up any debris / scale in the casing or tubing. Secondly, there is a need to provide high pressure jetting to the perforations or open hole section to cleanup any near wellbore damage.
- The WOS Jet Mill provides both in one tool in one single run enhancing production by removing the skin in the well and blockages which are hindering production.
- The WOS Jet Mill is laid with carbide on the face and backside of the mill and has high pressure jet nozzles built into the mill body.
- When run with a downhole motor our JET Mill cleans out and mills out any debris in the well with the added benefit of providing high pressure jetting.
- Operators then can provide full drift mechanical removal of any hard debris / sand and high-pressure jetting to clean perforations / tubing walls all in one run.

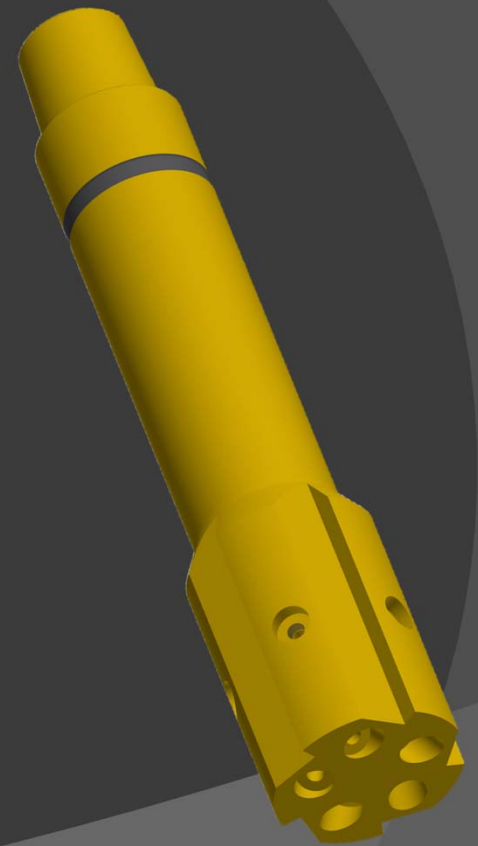

# Features

- 🌀 In house laid carbide on the face and backside of the mill
- 🌀 High pressure jet nozzles built into the mill body
- 🌀 Ability to provide full drift mechanical removal of any hard debris
- 🌀 All common mill sizes available with custom application options
- 🌀 Can be ran with standard completion fluids with nitrogen and acid



# Benefits

- ② Reduces fishing jobs with no moving parts
- ② Reduces trips with re-stimulation and cleanout operation in one run
- ② Allows for larger hole opening applications blasting away cement and formation
- ② Better cleaning with high pressure jetting through profiles



# Jet Mill Specs

Jet Mill				
Undressed OD (in)	1.780" - 2.750"	3.125" - 4.550"	6.125"	8.250"
Fishing Neck OD (in)	1.700"	2.875"	4.375"	5.875"
Fishing Neck Length (in)	5" - 6"	10"	8"	12"
Pin Connection	1" MT	2-3/8" PAC	3-1/2" REG	4-1/2" REG

# Contact Information

To secure the highest quality of tools engineered, manufactured and tested in the USA contact your local WOS representative or contacts below

Main phone - 346-774-4433

Email - [sales@wos.com](mailto:sales@wos.com)

# WOS Company Overview

- 🌀 Started Operations in Q3 2015
- 🌀 Fully Supported Downhole Tool Division
  - Design & Engineering
  - Machining & Fabrication
  - Field Operations
  - Rebuild & Redress
  - Evaluate Performance
- 🌀 Wireline
  - 4 trucks in the Northeast and 2 in West Texas
  - Started operations in July 2018
- 🌀 Operational Coverage
  - Pennsylvania, Ohio, West Virginia, and New York
  - Texas, New Mexico
  - North Dakota, Wyoming
  - Louisiana





# WOS Locations

